

2010/5/17

LUNASCAPE  
CORPORATION

## AFTERGLOW SETUP GUIDE

Afterglow Setup Guide Version 1.1

# Contents

Introduction .....	3
Afterglow Setup Guide .....	3
1 Set up the projector .....	3
2 Connect the camera .....	3
3 Launch Afterglow .....	3
4 License Activation (first run only) .....	4
5 Calibration (distortion compensation) .....	6
6 Webcam positioning .....	7
7 Adjusting the brightness .....	8
8 Laser Light Detection .....	10
9 Setup complete .....	15

# Introduction

---

This manual guides you through the steps necessary to set up your equipment (computer, projector and webcam) and software so that you can start using Afterglow.

## Afterglow Setup Guide

---

Please follow the instructions below to configure Afterglow correctly. If these instructions are not followed, Afterglow may not run properly.

### 1 Set up the projector

Connect the computer and the projector to a power source and connect the projector to the computer. Verify that the computer display is projected properly on the viewing screen.

### 2 Connect the camera

Connect the webcam to a USB port of the computer with a USB cable.

### 3 Launch Afterglow

After verifying that the computer and the webcam are properly connected, double-click the Afterglow icon to launch Afterglow.



#### 4 License Activation (first run only)

When launching Afterglow for the first time, a “License Activation” screen will appear, as shown below. License activation is necessary in order to use Afterglow. If the computer is connected to the internet, enter the Product Key (36 characters, including hyphens), into the “Product Key” box and click “Online Activation”.

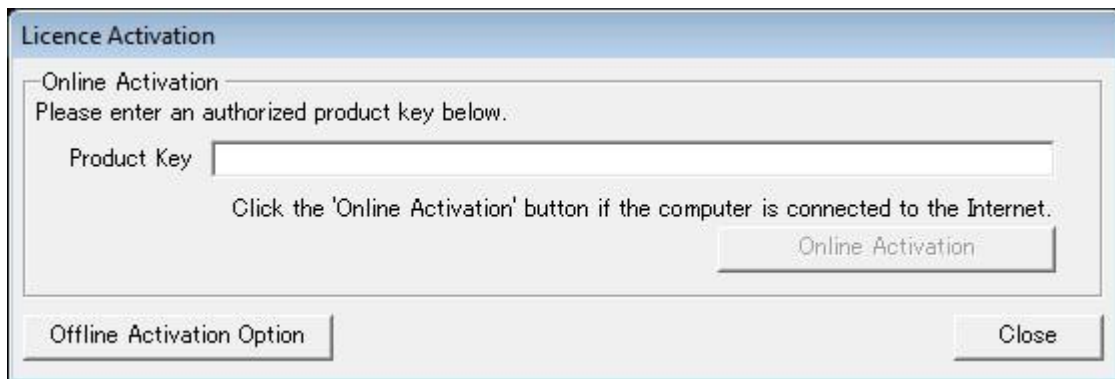

Once license activation is complete a message announcing its success will appear.

Note: The License Activation screen will be displayed only when running Afterglow for the first time. When launching Afterglow for the second time on the same computer, this dialog will not appear.

If the computer is not connected to the internet, License Activation can be performed offline. Click the “Offline Activation Option” button and follow the instructions in the window that appears.

The image shows a software dialog box titled "Licence Activation". It is divided into two main sections. The top section is titled "Online Activation" and contains a text prompt "Please enter an authorized product key below." followed by a text input field labeled "Product Key". Below the input field is the instruction "Click the 'Online Activation' button if the computer is connected to the Internet." and a button labeled "Online Activation". The bottom section is titled "Offline Activation" and contains the instruction "If the computer is not connected to the Internet,". It lists three steps: Step 1: "Enter Your Product Key and click the 'Request Offline Activation Key'." with a "Product Key" input field and a "Get Offline Activation Request Key" button; Step 2: "1. Send your Offline Activation Request Key from the popup window to keyrequest@afterglow-inc.com. 2. When Afterglow sends the Activation Key retype the product key in the space above, and continue to Step 3 to complete the activation process."; Step 3: "Enter Your Offline Activation Key and click the 'Offline Activation'". This section includes an "Activation Key" input field and an "Offline Activation" button. Between the two sections are two buttons: "Offline Activation Option" on the left and "Close" on the right.

## 5 Calibration (distortion compensation)

Next the Afterglow Quick Start screen will appear.

[Screen 1] (Afterglow Quick Start screen)

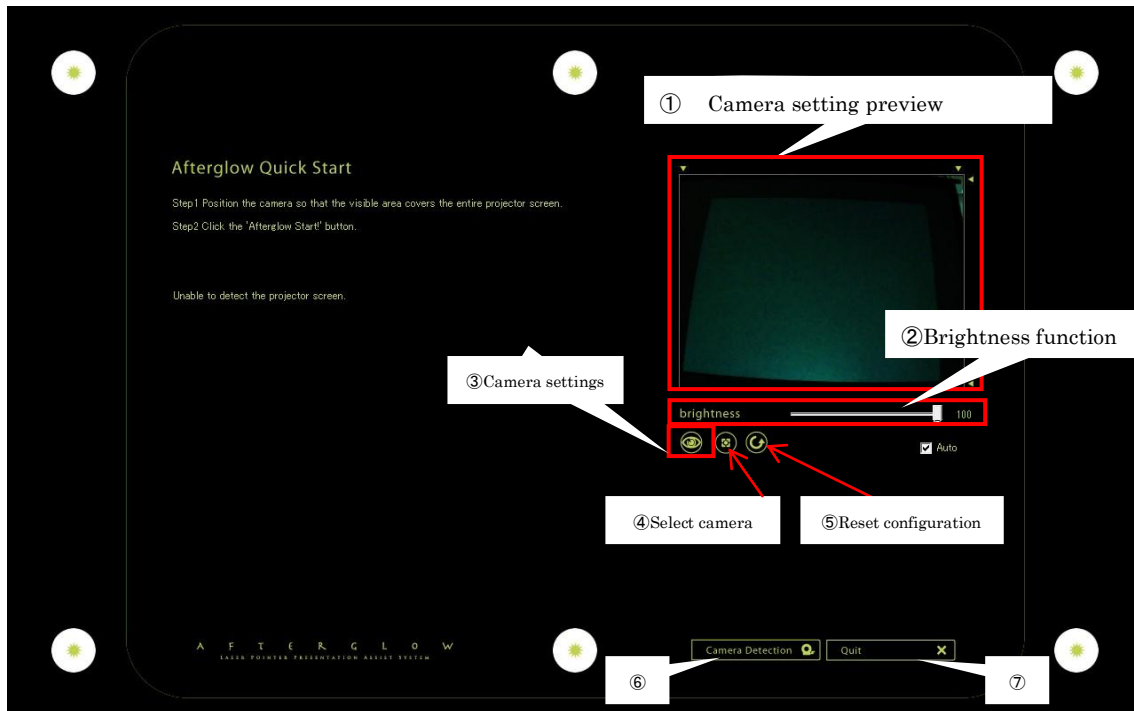

### Legend

- ① Camera setting preview screen: displays the view from the webcam
- ② Brightness function: sets the brightness of the camera setting preview screen
- ③ Camera settings: displays the webcam settings screen
- ④ Select camera: if several cameras are connected, this function selects a camera
- ⑤ Reset configuration: reset the camera settings
- ⑥ Camera detection: if no camera is detected, try again to detect one
- ⑦ Quit: quit Afterglow

## 6 Webcam positioning

Next, position the webcam while looking at the Camera setting preview screen (Screen 1-①).

Ensure that the camera is facing the screen and that the entire screen is visible in the preview window. The following two conditions must be satisfied:

- 6 white round dots must be displayed on the Camera setting preview screen
- A green frame must surround the entire visible area recognized by the webcam

In general the setup is complete if the webcam is set up in front of the screen and if the green frame is displayed on the Camera setting preview screen.

Once the webcam positioning is complete, a screen “Camera Settings Completed” will appear, see Screen 2 below, with a green frame and a message on the left saying “Projector Screen Detected!” This concludes the camera setup.

[Screen 2] (Camera Settings Completed)

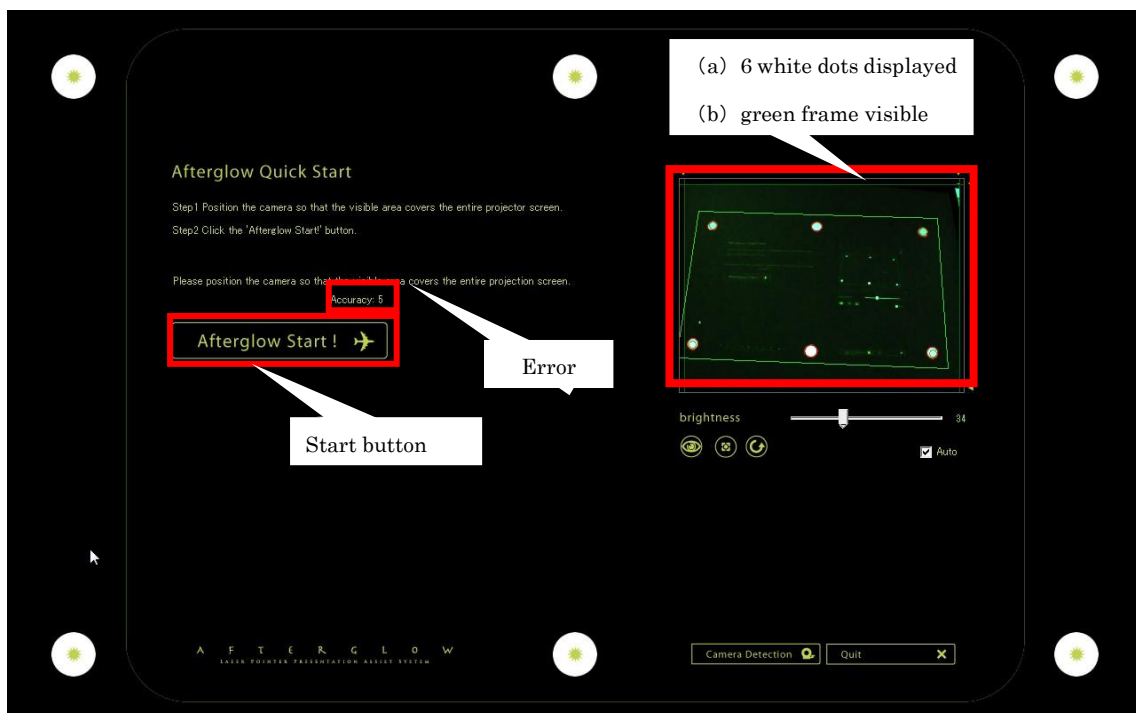

To the right of the “Projector Screen Detected!” message there is an automatically displayed “Error” indicator. This number indicates the inaccuracy of the correspondence between the actual screen and the webcam recognition screen. If this number is larger than 5 the webcam

should be repositioned so as to achieve an error smaller than 5. If the error is large Afterglow may not operate smoothly.

## 7 Adjusting the brightness

### 1. The brightness function

Normally the brightness need not be manually adjusted, as Afterglow automatically adapts the brightness at the time of webcam recognition. However, in the event that the camera fails to register the screen (i.e., no green frame appears), the brightness may have to be set manually using the brightness function until the screen is identified by the camera (i.e., until the green frame appears).

### 2. Cropping the video image area

The operation of the laser pointer may be affected by ambient light outside the area recognized by the camera (the green frame). In this case, adjust the video image area by moving the slides above and on the right of the Camera setting preview window.

[Screen 3] (Webcam video image area)

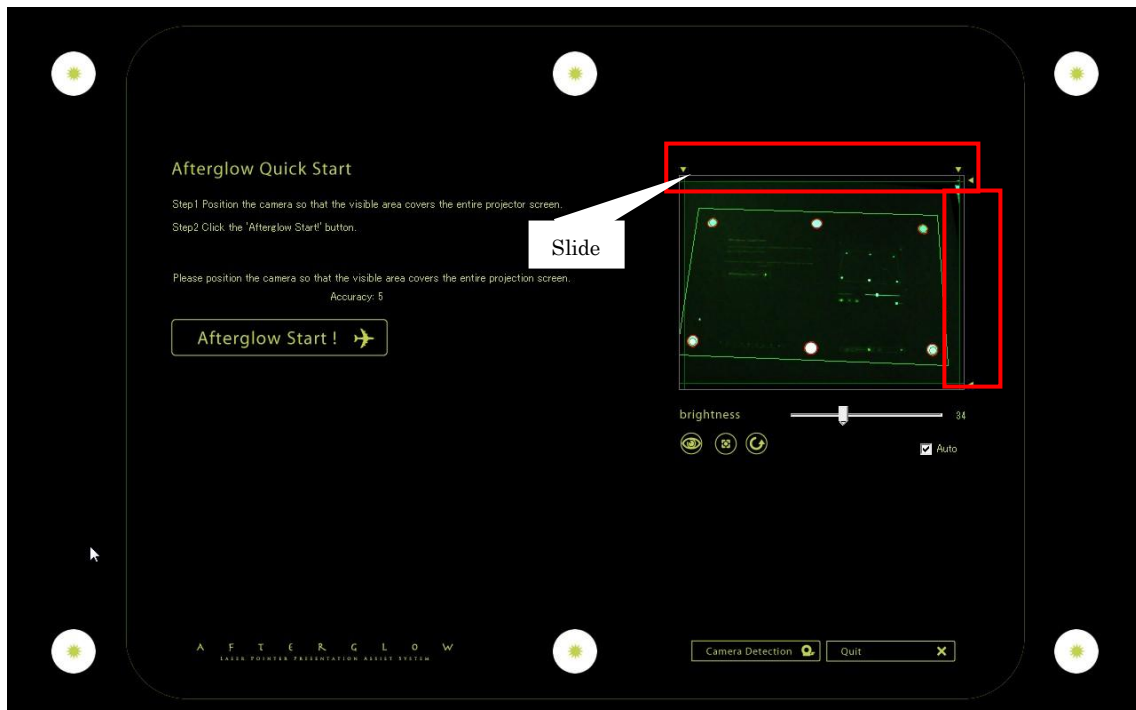

To start Afterglow, click the "Afterglow Start!" button.

A message “Afterglow Starting” will appear (see Screen 4) followed by a Laser Light Detection screen (see Screen 5).

[Screen 4] (Afterglow Startup Screen)

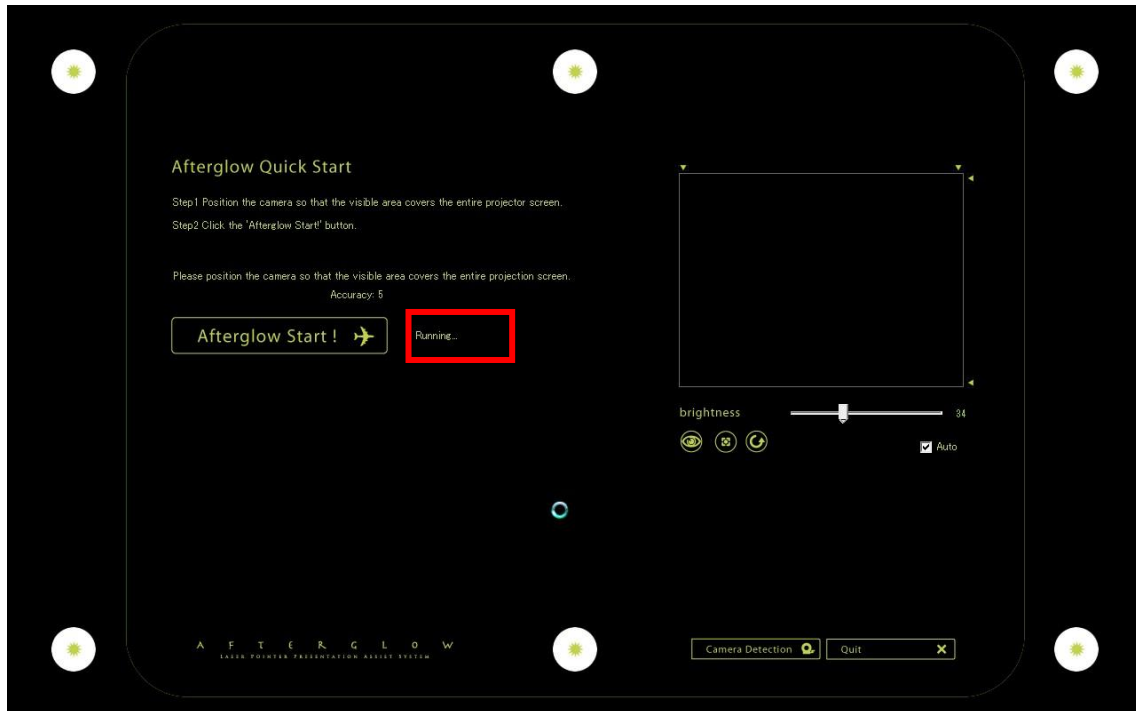

## 8 Laser Light Detection

[Screen 5] (Laser Light Detection Screen)



Next, follow the steps below to configure Laser Light Detection.

1. Point the laser at the webcam video image area in the center of Screen 5 (inside the red frame) and draw large circles and lines to verify that the light is properly recognized.
2. While drawing circles and lines, a square dot surrounded by a red frame appears (Screen 6).

[Screen 6]



This red-framed dot is the light point of the laser pointer, and should remain the only point displayed as the pointer is moved around. To render the dot stable, adjust the brightness with the brightness function slider. Moving the slider to the right makes the dot brighter. Click “OK” when the brightness is satisfying.

Note: After completing configuration, any remaining lines may be removed by selecting “clear” in the panel on the right.

**A correctly configured screen**

The red-framed square dot is the only dot displayed, and it is stable.

(The webcam recognizes only the light-point of the laser pointer and any lines drawn by the laser pointer are displayed in a stable manner.)

[Screen 7]

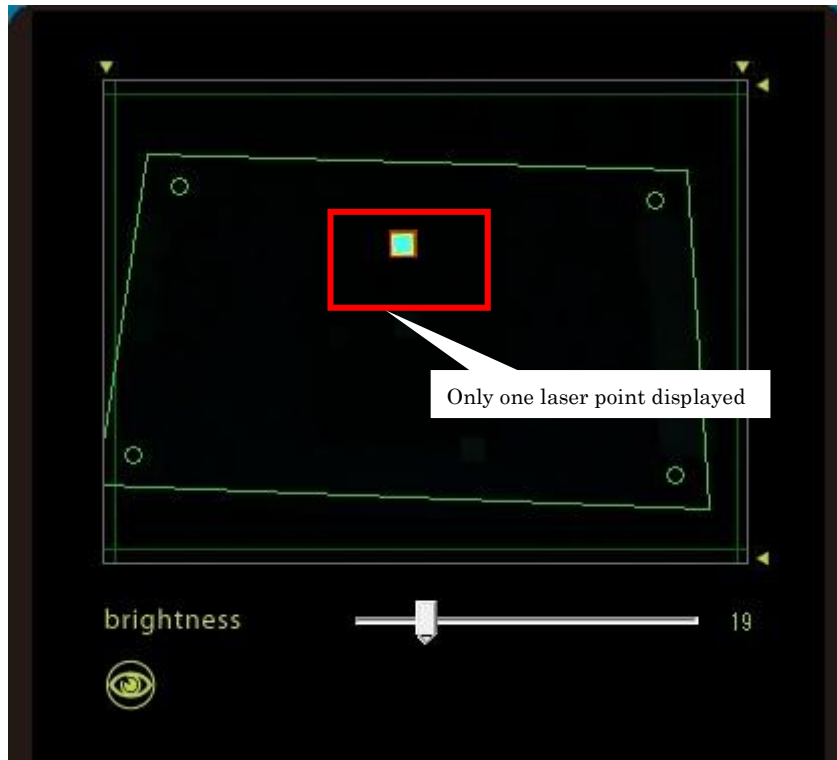

### Incorrectly configured screens

- The screen is too bright, and several light points have been detected.

(In this case, light points apart from that of the laser pointer have been recognized, and it is not possible to draw stable lines with the pointer.)

Note: To correct the situation, use the brightness function to lower the brightness level.

[Screen 8]

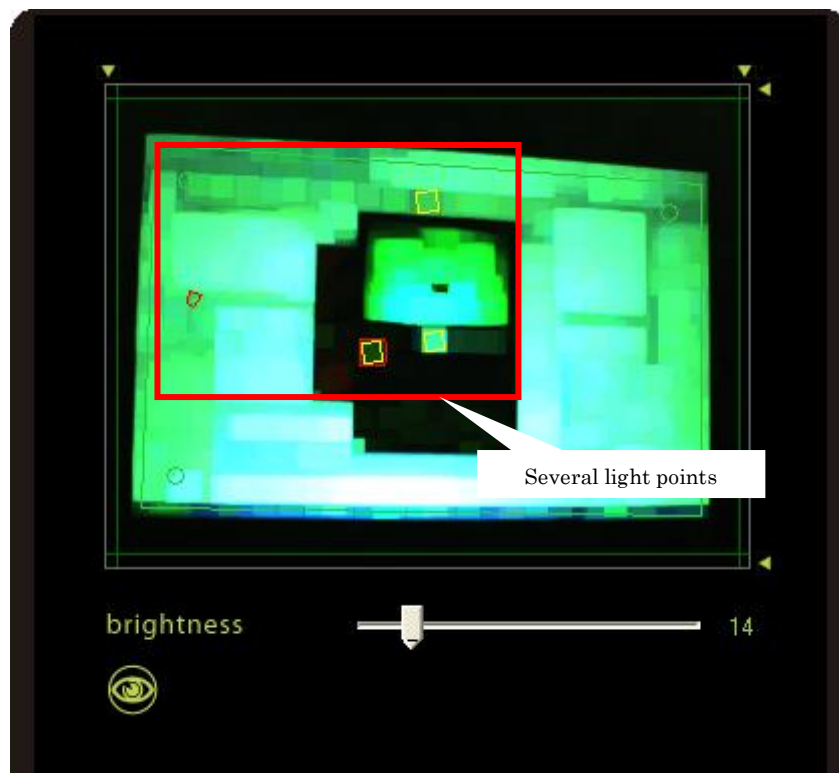

- The screen is too dark and the light point of the laser pointer fails to be detected. (In this case, since the laser pointer has not been recognized, it is not possible to draw lines with the pointer.)  
Note: To correct the situation, use the brightness function to make the screen brighter.

[Screen 9]

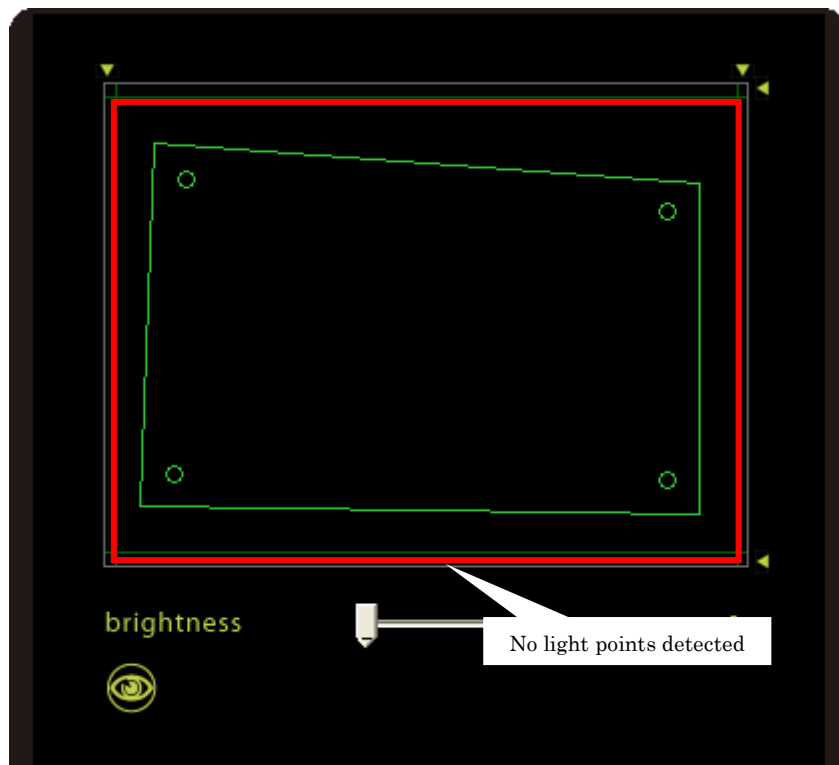

## 9 Setup complete

This concludes the Afterglow setup, and a screen like the one below will be displayed.

[Screen 10]



Verify that you can draw on the screen with the laser pointer. If you can draw on the screen to obtain an image like Screen 11, then the setup has been correctly completed, and you can proceed to use Afterglow.

[Screen 11]

